

Step 2: Record color of
heat shrink on harness
to each servo

Step 1: Remove Pins

Step 3: Remove
(3) flange nuts
securing servo
assembly

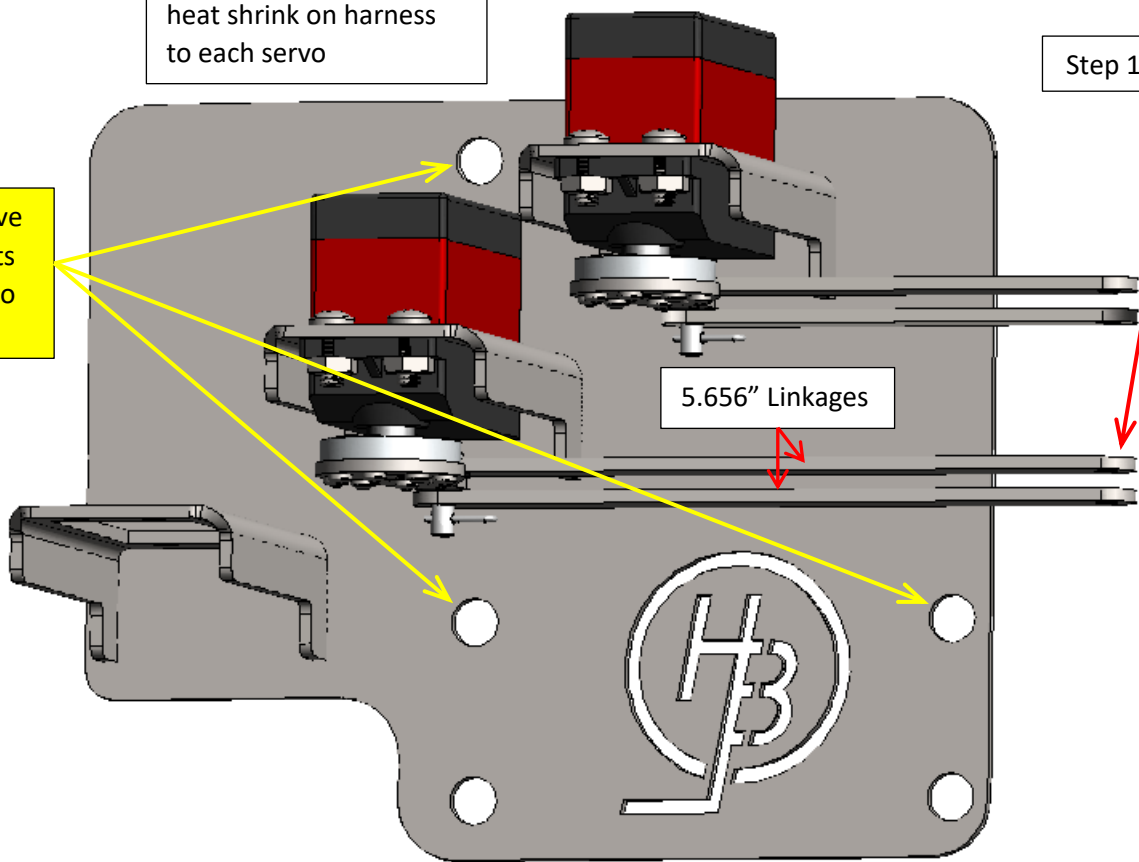

Step 4: Remove (4) bolts
securing LOAD/UNLOAD
servo to servo assembly

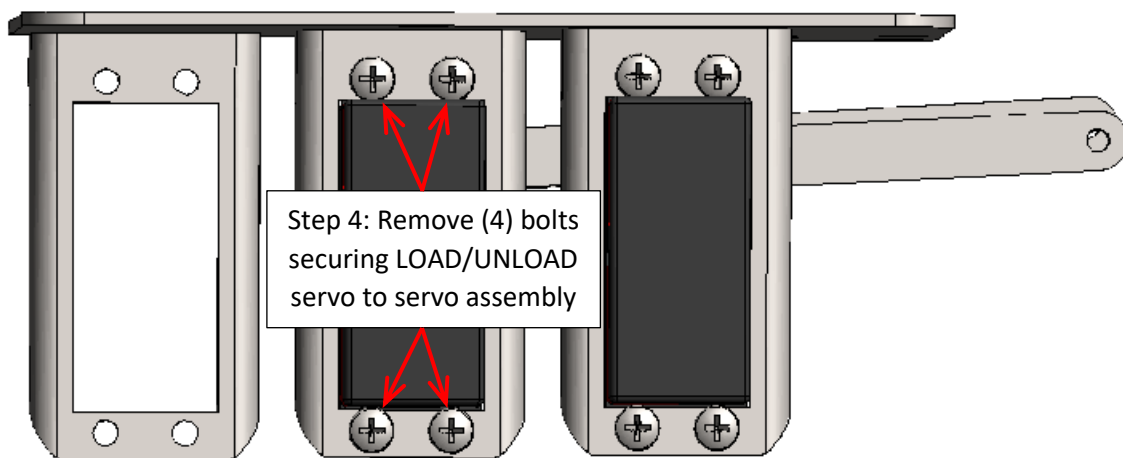

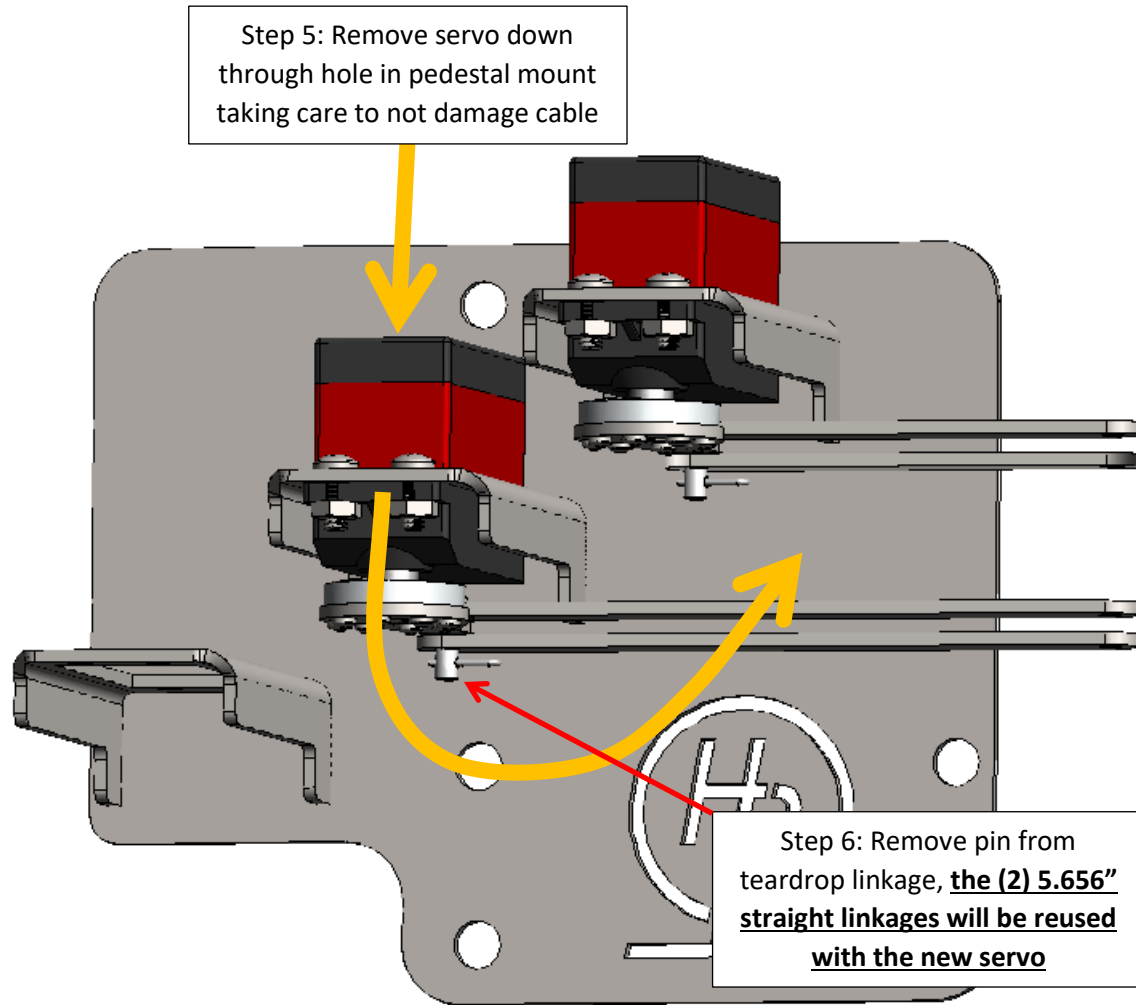

Step 7: Install new servo and secure using reverse of steps 5 & 4. Pin (2) 5.656" straight linkages to new servo using reverse of step 6.

Step 8: Secure servo assembly using reverse of step 3

Step 9: Plug harnesses into corresponding servos using the data recorded in step 2.

Step 10: Pin 5.656" linkages to valve handle

Complete